

**PE324T-40-4**

**GENERAL PURPOSE ELECTRIC MOTOR**

**NEMA PREMIUM EFFICIENCY**

**TOTALLY ENCLOSED FAN COOLED**

**INVERTER DUTY 10:1 CT; 20:1 VT - NEMA MG1 PART 31**

Factory Certified for T2B Class I, Division II, Groups A,B,C & D and Class II, Division II, Groups F & G

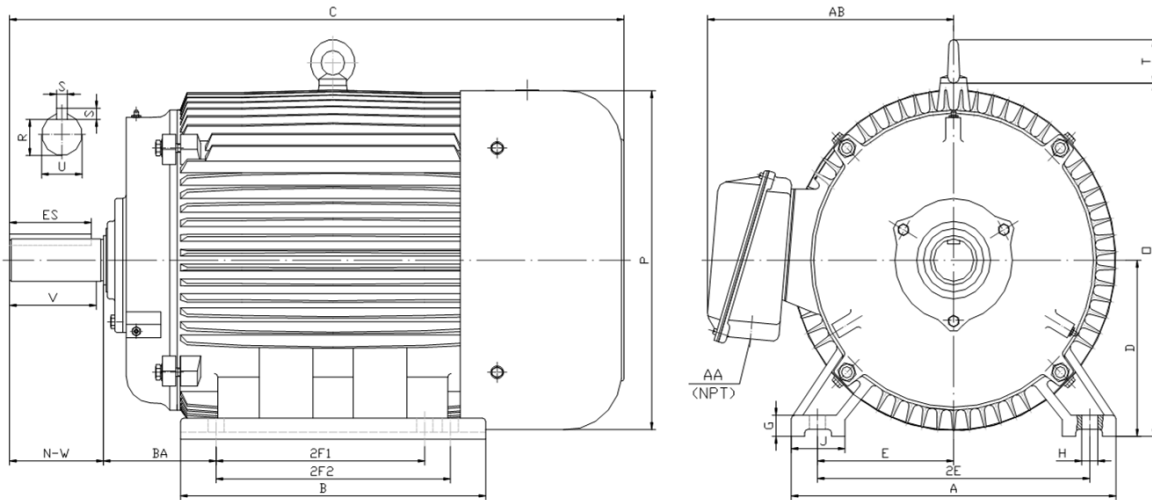

**DIMENSIONS**

| HP | RPM  | Frame | MOUNTING |       |       |      |      |      |      |      |       |       |      |       |       |      |      |
|----|------|-------|----------|-------|-------|------|------|------|------|------|-------|-------|------|-------|-------|------|------|
|    |      |       | A        | B     | C     | D    | G    | H    | J    | E    | 2E    | 2F1   | 2F2  | O     | P     | T    | BA   |
| 40 | 1800 | 324T  | 15.50    | 14.70 | 29.80 | 8.00 | 1.00 | 0.66 | 2.75 | 6.25 | 12.50 | 10.50 | 0.00 | 15.90 | 15.70 | 2.60 | 5.25 |

| Shaft Extension, Key Set |      |       |       |      |      | Conduit Box |       | Bearings |      | Mount |
|--------------------------|------|-------|-------|------|------|-------------|-------|----------|------|-------|
| U                        | V    | R     | S     | ES   | N-W  | AA          | AB    | DE       | ODE  |       |
| 2.125                    | 5.00 | 1.845 | 0.500 | 3.91 | 5.25 | 2.00        | 12.30 | 6312     | 6312 | F1    |

**BEARING LUBRICATION:** The bearings come lubricated with Mobil Polyrex EM Polyurea Grease. It is recommended that you add some additional lubrication when the motor is installed.

Three options (brands) for suitable lubrication include, but are not limited to, the following:

- 1.) Mobil Polyrex EM
- 2.) Citco Polyurea MP
- 3.) Conoco Phillips Polytac EP



**Electrical Helper**

"Practical Straight Forward Electric Wiring Solutions Since 1928."

For Fast & Friendly Assistance Call Us  
888-226-4917  
Hours 8:00AM-5:00PM CST



## PE324T-40-4

**GENERAL PURPOSE ELECTRIC MOTOR**

**NEMA PREMIUM EFFICIENCY**

**TOTALLY ENCLOSED FAN COOLED**

**INVERTER DUTY 10:1 CT; 20:1 VT - NEMA MG1 PART 31**







Factory Certified for T2B Class I, Division II, Groups A,B,C & D and Class II, Division II, Groups F & G

### PERFORMANCE DATA

| HP | RPM  | Frame | Voltage     | Frequency (Hz) | Full Load S.F. | Insulation Class | NEMA Design | Slip (%) | NEMA Code | Enclosure Type | IP Rating | Max. Ambient |
|----|------|-------|-------------|----------------|----------------|------------------|-------------|----------|-----------|----------------|-----------|--------------|
| 40 | 1780 | 324T  | 208-230/460 | 60             | 1.15           | F                | B           | 1.1      | G         | TEFC           | 55        | 40° C        |

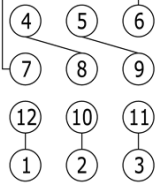
| Amps (460V) |     | Efficiency (%) |      |      |      | Power Factor |       |       | Torque (ft-lb) |       |       | DE Bearing | ODE Bearing | Connection   | Weight (lbs.) |
|-------------|-----|----------------|------|------|------|--------------|-------|-------|----------------|-------|-------|------------|-------------|--------------|---------------|
| FLA         | LRA | 100%           | 75%  | 50%  | Min. | 100%         | 75%   | 50%   | FLT            | LRT % | BDT % |            |             |              |               |
| 48.0        | 290 | 94.1           | 94.6 | 94.6 | 93.0 | 0.830        | 0.790 | 0.700 | 118.8          | 160   | 245   | 6312       | 6312        | 12 Lead 2Δ/Δ | 519           |

### NAME PLATE

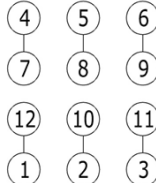
|  |           |                         |               |                       |        |           |  |  |       |   |  |  |  |  |  |  |
|--|-----------|-------------------------|---------------|-----------------------|--------|-----------|--|--|-------|---|--|--|--|--|--|--|
|  <b>North American Electric, Inc.</b> |           |                         |               |                       |        |           |  |  |       |   |  |  | <b>CONNECTION DIAGRAMS</b><br><b>208-230V</b><br> |  |  |  |
| <b>INVERTER DUTY 20:1 VT; 10:1 CT</b>  |           |                         |               |                       |        |           |  |  |       |   |  |  |  |  |  |  |
| CAT NO: PE324T-40-4  |           |                         | FRAME 324T    |                       |        | PHASE 3   |  |  |       |   |  |  |  |  |  |  |
| HZ 60  | S.F. 1.15 | HZ 50                   | S.F. 1.0      | ENCL TEFC             | IP 55  |           |  |  |       |   |  |  |  |  |  |  |
| HP 40  | RPM 1780  | HP 40                   | RPM 1470      | DUTY CONT             | DES B  |           |  |  |       |   |  |  |  |  |  |  |
| VOLTS 208-230/460  |           |                         | VOLTS 190/380 |                       |        | AMB 40° C |  |  | INS F |   |  |  |  |  |  |  |
| FLA 106.2 - 96 / 48  |           | FLA 115/57.5            |               | DE BEARING 6312       |        |           |  |  |       |   |  |  |  |  |  |  |
| CODE G   | P.F. 0.83 | CODE D                  | P.F. 0.85     | ODE BEARING 6312      |        |           |  |  |       |   |  |  |  |  |  |  |
| EFF 94.1   | MIN 93.0  | EFF 93                  | MIN 91.7      | LUB: Mobil Polyrex EM |        |           |  |  |       |   |  |  |  |  |  |  |
| MOTOR WEIGHT 519 LBS   |           | CONNECTION 12 Lead 2Δ/Δ |               |                       | SER NO |           |  |  |       |   |  |  |  |  |  |  |
| General purpose use on industrial machinery installed in damp, dusty or dirty environments.<br>Hernando, Mississippi     |           |                         |               |                       |        |           |  |  |       |    CC 082A |  |  | <b>460V</b><br>                                   |  |  |  |

### APPLICATIONS:

General purpose use on pumps, fans, blowers, compressors, conveyors, material handling and other industrial machinery installed in damp, dusty or dirty environments.



**Electrical Helper**

"Practical Straight Forward Electric Wiring Solutions Since 1928."

For Fast & Friendly Assistance Call Us  
888-226-4917

Hours 8:00AM-5:00PM CST